

# Style-P 1209

Indoor Lighting - Suspended



## TECHNICAL INFORMATION

<b>Housing</b>	Extruded aluminum profile housing
<b>Optics</b>	UV-stabilized opal diffuser
<b>LED Lifetime</b>	50.000 hours
<b>Mounting System</b>	Pendant

## OPTICAL SPECIFICATIONS

<b>Optical</b>	Symmetrical
<b>Light Exit Angle</b>	120°
<b>UGR Value</b>	80

## ELECTRICAL

<b>Power (W)</b>	41W
<b>Power Factor</b>	>95
<b>Light Source</b>	SMD Mid Power LED
<b>Cabling</b>	Halogen-Free
<b>Input Voltage</b>	220-240V / 50-60 Hz

## OPTIONAL

DALI  
Emergency Lighting Unit

## MOUNTING

**Mounting Type** Pendant

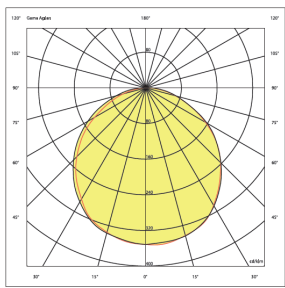
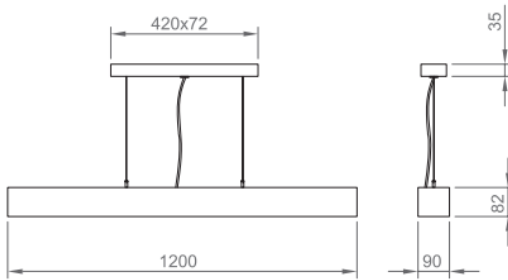

Order Code	W	Light Source	Lm	CCT	WxLxH (mm)	Kg
03137.91.30.034	41	LED Module	3470	3000	90x1200x82	4,2
03137.91.40.036	41	LED Module	3670	4000	90x1200x82	4,2

All electrical values given are nominal values. The luminous flux and the associated electrical load are subject to an initial tolerance of +/- 10%. Color temperature tolerance: +/-150 K. Unless otherwise stated, values are valid for an ambient temperature of 25°C.  
The information containing technical parameters and product codes in the catalog and on the website may differ from standard products due to customizations made according to projects.  
Ikizler Aydınlatma has the right to make changes to the products without notice. You can get up-to-date information about the products on our website.

**Phone:** +90 (216) 397 22 16  
**Fax:** +90 (216) 397 19 19  
**E-Mail:** [info@ikizleraydinlatma.com](mailto:info@ikizleraydinlatma.com)

Please visit our website for our updated information. [www.ikizleraydinlatma.com](http://www.ikizleraydinlatma.com)

