

BEAM-D



Color Options  Dark gray



OPTICAL

Up&Down light distribution
43° beam angle
Luminous efficacy >100 lm/W
Lifetime (L80/B20): 50000 h. (tq+25°C)
COB LED module
Color rendering index: CRI>80

MECHANICAL

Die-cast aluminium housing
Bright reflector
Tempered transparent glass
IP65 protection degree
Impact resistance IK08
Glow-wire test resistance 650°C

ELECTRICAL

Halogen-free wiring
220-240V-50/60Hz
Power factor >0.95
Constant current, Class I, isolated driver
CE - IEC 60598-1 - EN 60598-1
Ambient temperature from -20°C to +50°C
On-Off Control - (Code: .N000)

OPTIONAL

CRI>90
Single sided light (Beam-S)
Color temperature (K) options

INSTALLATION

Wall surface mounted.

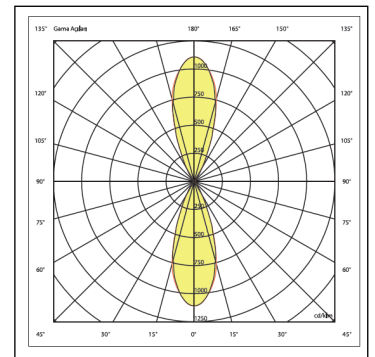
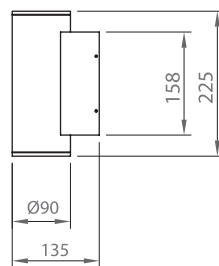

Product Code	Power (W)	Lumen (lm)	CCT (K)	CRI	Dimensions WxLxH (mm)	Cut-Out Q (mm)	Weight (kg)
06602.91.40.023	2x13	2650	4000K	Ra>80	90x225x135	N/A	1,8

All electrical values given are rated values. Luminous flux and connected electrical load are subject to an initial tolerance of +/- 10%. Tolerance of colour temperature: +/-150 K. Unless stated otherwise, the values apply to an ambient temperature of 25°C.

Any information including technical parameters and product codes may differ from standard products in catalogue & web site due to customization made per projects.

Ikizler Lighting has the right to make changes or cancellations on the products without notification. Updated information on the products can be received from our web site.